

山口市宮野下恋路

物件概要

- 所在地:山口市宮野下恋路
- 地目:宅地
- 用途地域:第一種低層住居専用地域・第二種住居地域
- 建ぺい率:40%・60%
- 容積率:60%・200%
- 設備:上下水道(下水道負担金ありm²/360円)・中国電力・都市ガス
- 取引形態:売主
- 手数料 なし
- 開発許可 平成30年6月5日 開第36号

特約事項 敷地内での洗剤を使用した車の洗車は禁止となります。

	面積	坪単価	価格
2号地	227.24m ² (68.74坪)	98,000円	6,733,000円
3号地	227.80m ² (68.90坪)	118,000円	8,126,000円
4号地	226.35m ² (68.47坪)	118,000円	8,077,000円
5号地	205.62m ² (62.20坪)	108,000円	6,711,000円
商談中(6号地)	254.60m ² (77.01坪)	100,000円	7,698,000円
7号地	235.78m ² (71.32坪)	100,000円	7,136,000円
8号地	210.80m ² (63.76坪)	118,000円	7,522,000円
11号地	210.00m ² (63.52坪)	115,000円	7,305,000円
12号地	216.08m ² (65.36坪)	98,000円	6,410,000円
13号地	215.20m ² (65.09坪)	100,000円	6,506,000円
14号地	215.20m ² (65.09坪)	113,000円	7,254,000円
17号地	251.29m ² (76.01坪)	105,000円	7,971,000円
20号地	229.22m ² (69.33坪)	88,000円	6,101,000円
21号地	263.36m ² (79.66坪)	88,000円	7,009,000円
22号地	275.92m ² (83.46坪)	88,000円	7,091,000円

※ 敷地内に電柱が建つ可能性があります。

成泰不動産 株式会社
山口市小郡下郷323番地16
TEL 083-972-2255
FAX083-972-2239

物件のお問合せは 成泰不動産 柴田 090-4825-8409迄 お願いします。

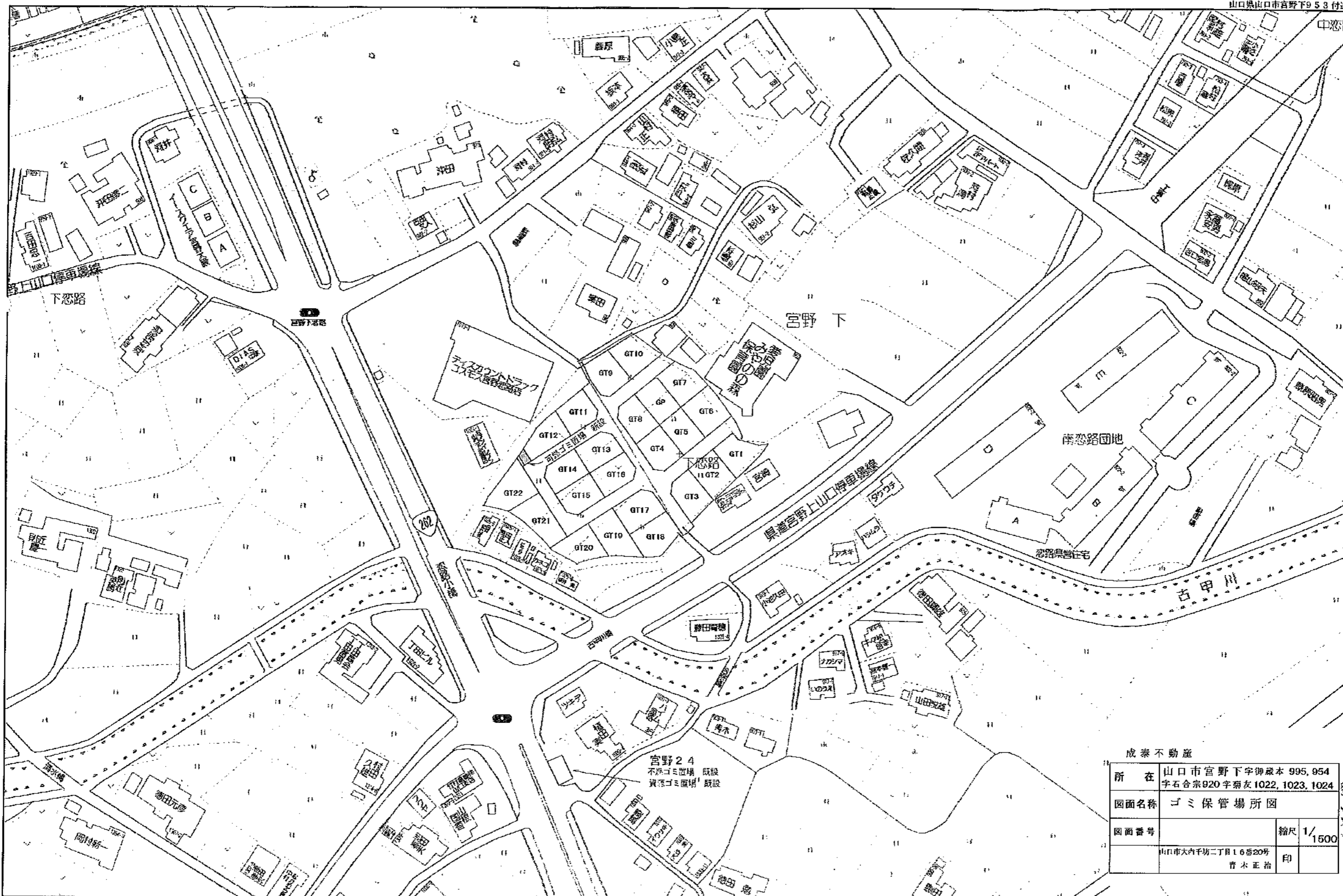

成泰不動産

所在	山口市宮野下字御蔵本 995, 954 字石合宗920字菊友1022, 1023, 1024		
図面名称	ゴミ保管場所図		
図面番号		縮尺	1/1500
	山口市大内千坊二丁目16番20号 青木正治		印

用途廃止面積一覧表

符号	宅地計	用地面積
ZR1		15.94 m ²
ZR2	道路計	10.27 m ²
ZR3		3.06 m ²
ZW1		13.64 m ²
ZW2		18.83 m ²
ZW3		18.95 m ²
ZW4		16.91 m ²
ZW5	水路計	0.52 m ²
ZW6		2.34 m ²
合計面積		100.46 m ²

確定後 宅地面積一覧表

符号	宅地計	用地面積
T1-1		217.61 m ²
ZR3		3.06 m ²
ZW6		2.34 m ²
T1-2	223.14	0.13 m ²
T2		227.24 m ²
T3		227.80 m ²
T4-1		101.71 m ²
ZW3		18.95 m ²
ZR1		15.94 m ²
T4-2	226.35	89.75 m ²
T5-1		162.04 m ²
ZW4		18.91 m ²
ZR2		10.27 m ²
T5-2	205.62	16.40 m ²
T6-1		235.25 m ²
ZW2		18.83 m ²
ZW5	254.60	0.52 m ²
T7		222.14 m ²
ZW1	235.78	13.64 m ²
T8		210.80 m ²
T9		237.43 m ²
T10		228.93 m ²
T11		210.00 m ²
T12		216.08 m ²
T13		215.20 m ²
T14		212.20 m ²
T15		216.07 m ²
T16		215.19 m ²
T17		251.29 m ²
T18		252.32 m ²
T19		260.34 m ²
T20		229.22 m ²
T21		263.36 m ²
T22		275.92 m ²
合計面積		5094.88 m ²

T	宅地計	5094.88	73.59
(用途廃止 道路・水路も含む)			
SR	道路(相互編入)	53.27	0.77
R	開発道路(寄付)	1187.39	17.15
SW	水路(相互編入)	125.49	1.81
P	公園(寄付)	208.73	3.01
G1	ゴミ置場(寄付)	20.61	0.30
KR	遊路(加工)	111.12	1.60
YR	遊路(用途変更)	6.12	0.09
KW	水路(加工)	20.59	0.30
YW	水路(用途変更)	79.81	1.15
HR	その他道路+通路	15.59	0.23
合計面積		6923.60m ²	100.00

区域外加工面積一覧表

符号	計	用地面積
GKR1		9.69 m ²
GKR2		40.38 m ²
GKR3		12.64 m ²
GKR4		67.76 m ²
GKR6		21.91 m ²
GKR6		12.34 m ²
GKR7	道路計 108.16	33.46 m ²
GKW1		49.85 m ²
GKW2		9.02 m ²
GKW3		52.12 m ²
GKW4	水路計	91.39 m ²
GKW5		3.67 m ²
合計面積		404.21 m ²

成泰不動産

所在	山口市宮野下字御蔵本 995, 954 字石合宗 920 字菊友 1022, 1023, 1024
図面名称	確定図求積表
図面番号	1 / 3 縮尺 1/350
	山口市大内千坊二丁目 16番20号 青木正治 印

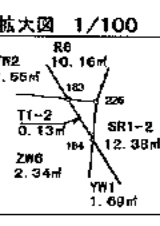
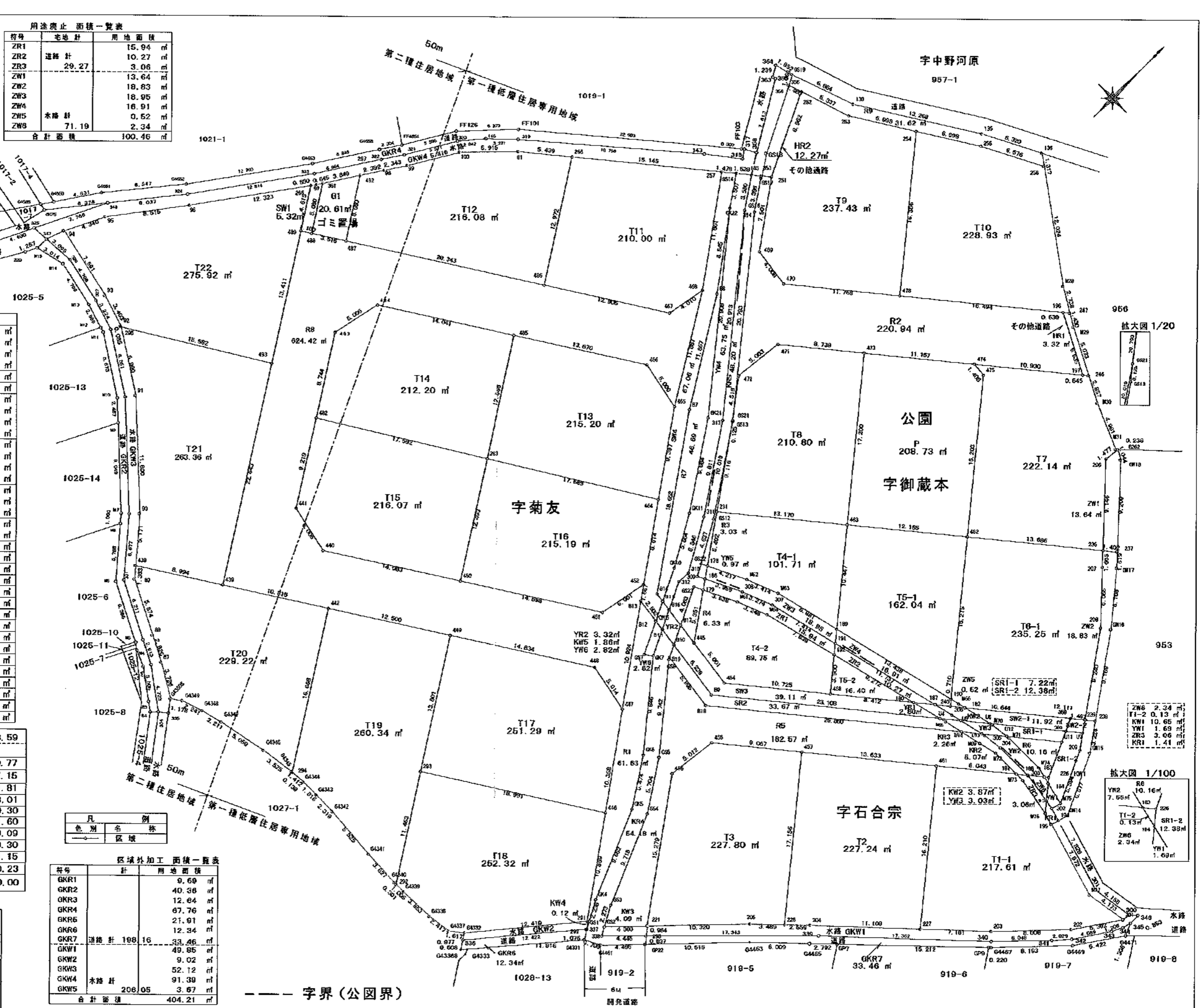

--- 字界(公図界)

地籍 T1-1 table with columns: 测点, X, Y, 辺長. Includes points 481, 181, M73, M76, 195, M77, 201, 202, 203, 227 and summary statistics.

地籍 T4-2 table with columns: 测点, X, Y, 辺長. Includes points 454, 446, 179, M81, M64, 192, 456 and summary statistics.

地籍 ZW1 table with columns: 测点, X, Y, 辺長. Includes points 206, 0262, 0W18, 237, 236 and summary statistics.

地籍 T16 table with columns: 测点, X, Y, 辺長. Includes points 464, 452, 451, 450, 236 and summary statistics.

地籍 G1 table with columns: 测点, X, Y, 辺長. Includes points 487, 488, 351, 492 and summary statistics.

地籍 R6 table with columns: 测点, X, Y, 辺長. Includes points 0S8, B10, B18, U14, M69, M72, 181, 461, 457, 455, 456, 360, U11, U12, 0S2, 0S3, 0S4, 0S5 and summary statistics.

地籍 ZR3 table with columns: 测点, X, Y, 辺長. Includes points 181, 188, 303, 193, M76, M73 and summary statistics.

地籍 T5-1 table with columns: 测点, X, Y, 辺長. Includes points 483, 462, 190, 189, 199 and summary statistics.

地籍 T8 table with columns: 测点, X, Y, 辺長. Includes points 231, 0S13, 0S21, 472, 471, 473, 463 and summary statistics.

地籍 T17 table with columns: 测点, X, Y, 辺長. Includes points 449, 448, 447, 446, 293 and summary statistics.

地籍 SR1-1 table with columns: 测点, X, Y, 辺長. Includes points 360, U11, U12, M70, U6 and summary statistics.

地籍 R6 table with columns: 测点, X, Y, 辺長. Includes points U12, U11, 226, 183, M74, M71 and summary statistics.

地籍 ZW6 table with columns: 测点, X, Y, 辺長. Includes points 188, 183, 184, 193, 303 and summary statistics.

地籍 ZW4 table with columns: 测点, X, Y, 辺長. Includes points 189, 190, 240, 187, 191 and summary statistics.

地籍 T9 table with columns: 测点, X, Y, 辺長. Includes points 470, 499, 251, 252, 253, 254, 478 and summary statistics.

地籍 T18 table with columns: 测点, X, Y, 辺長. Includes points 446, 291, G4332, G4337, G4338, G4339, 292, 293 and summary statistics.

地籍 SR1-2 table with columns: 测点, X, Y, 辺長. Includes points 360, U7, 209, M75, 184, 226, U11 and summary statistics.

地籍 R7 table with columns: 测点, X, Y, 辺長. Includes points GK22, GK21, GK11, GK10, B15, B14, B7, BB and summary statistics.

地籍 T1-2 table with columns: 测点, X, Y, 辺長. Includes points 184, 183, 226 and summary statistics.

地籍 ZR2 table with columns: 测点, X, Y, 辺長. Includes points 191, 187, 180, 192 and summary statistics.

地籍 T10 table with columns: 测点, X, Y, 辺長. Includes points 254, 255, 256, M28, 247, 196, 476 and summary statistics.

地籍 T19 table with columns: 测点, X, Y, 辺長. Includes points 292, G4340, G4341, G4342, G4343, G4344, 294, 442, 449, 293 and summary statistics.

地籍 SR2 table with columns: 测点, X, Y, 辺長. Includes points 360, B9, U4, M65, U14, B18, B19 and summary statistics.

地籍 R8 table with columns: 测点, X, Y, 辺長. Includes points 489, 468, 487, 486, 467, 469, 465, 466, 465, 484, 483, 482, 441, 440, 450, 451, 452, 447, 448, 449, 448, 442, 439, 493 and summary statistics.

地籍 T2 table with columns: 测点, X, Y, 辺長. Includes points 457, 461, 227, 204, 228 and summary statistics.

地籍 T6-2 table with columns: 测点, X, Y, 辺長. Includes points 192, 180, 458 and summary statistics.

地籍 T11 table with columns: 测点, X, Y, 辺長. Includes points 257, 488, 467, 486, 288 and summary statistics.

地籍 T20 table with columns: 测点, X, Y, 辺長. Includes points 439, 442, 294, G4345, G4346, G4347, G4348, G4349, G4350S, 87, 88, 89, 438 and summary statistics.

地籍 SR1 table with columns: 测点, X, Y, 辺長. Includes points B13, B12, GS7, GK7, GK6, GK5, GK4, GS1, 201, 446, 447 and summary statistics.

地籍 R9 table with columns: 测点, X, Y, 辺長. Includes points 489, 468, 487, 486, 467, 469, 465, 466, 465, 484, 483, 482, 441, 440, 450, 451, 452, 447, 448, 449, 448, 442, 439, 493 and summary statistics.

地籍 T3 table with columns: 测点, X, Y, 辺長. Includes points 221, 456, 455, 457, 228, 205 and summary statistics.

地籍 T6-1 table with columns: 测点, X, Y, 辺長. Includes points 462, 236, 207, 208, 239, 122, 121, M66, 190 and summary statistics.

地籍 T12 table with columns: 测点, X, Y, 辺長. Includes points 488, 487, 492, 98, 99, 100, 81, 288 and summary statistics.

地籍 T21 table with columns: 测点, X, Y, 辺長. Includes points 493, 439, 438, 90, 91, 296 and summary statistics.

地籍 R1 table with columns: 测点, X, Y, 辺長. Includes points B13, B12, GS7, GK7, GK6, GK5, GK4, GS1, 201, 446, 447 and summary statistics.

地籍 R9 table with columns: 测点, X, Y, 辺長. Includes points 489, 468, 487, 486, 467, 469, 465, 466, 465, 484, 483, 482, 441, 440, 450, 451, 452, 447, 448, 449, 448, 442, 439, 493 and summary statistics.

地籍 T4-1 table with columns: 测点, X, Y, 辺長. Includes points 231, 463, 189, M63, M62, 178 and summary statistics.

地籍 ZW2 table with columns: 测点, X, Y, 辺長. Includes points 236, 237, 0W17, 0W16, 236, 239, 208, 207 and summary statistics.

地籍 T13 table with columns: 测点, X, Y, 辺長. Includes points 464, 466, 466, 465, 283 and summary statistics.

地籍 T22 table with columns: 测点, X, Y, 辺長. Includes points 489, 493, 296, 92, 93, 94, 95, 96, 255 and summary statistics.

地籍 R2 table with columns: 测点, X, Y, 辺長. Includes points 0S21, 0S16, 0S17, 353, 251, 469, 470, 478, 196, 197, 474, 473, 471, 472 and summary statistics.

地籍 R9 table with columns: 测点, X, Y, 辺長. Includes points 489, 468, 487, 486, 467, 469, 465, 466, 465, 484, 483, 482, 441, 440, 450, 451, 452, 447, 448, 449, 448, 442, 439, 493 and summary statistics.

地籍 ZW3 table with columns: 测点, X, Y, 辺長. Includes points 178, M66, M62, M63, 189, 191, 307, 308, 186 and summary statistics.

地籍 ZW5 table with columns: 测点, X, Y, 辺長. Includes points 190, M66, 182, 240 and summary statistics.

地籍 T14 table with columns: 测点, X, Y, 辺長. Includes points 482, 483, 484, 485, 283 and summary statistics.

地籍 T23 table with columns: 测点, X, Y, 辺長. Includes points 489, 493, 296, 92, 93, 94, 95, 96, 255 and summary statistics.

地籍 R2 table with columns: 测点, X, Y, 辺長. Includes points 0S21, 0S16, 0S17, 353, 251, 469, 470, 478, 196, 197, 474, 473, 471, 472 and summary statistics.

地籍 R9 table with columns: 测点, X, Y, 辺長. Includes points 489, 468, 487, 486, 467, 469, 465, 466, 465, 484, 483, 482, 441, 440, 450, 451, 452, 447, 448, 449, 448, 442, 439, 493 and summary statistics.

地籍 ZR1 table with columns: 测点, X, Y, 辺長. Includes points 186, 308, 307, 191, 192, M64, M61, 179 and summary statistics.

地籍 T7 table with columns: 测点, X, Y, 辺長. Includes points 462, 475, 474, 197, 246, M30, M31, 0262, 228, 236 and summary statistics.

地籍 T15 table with columns: 测点, X, Y, 辺長. Includes points 460, 440, 441, 462, 283 and summary statistics.

地籍 P table with columns: 测点, X, Y, 辺長. Includes points 463, 473, 474, 475, 462 and summary statistics.

地籍 R3 table with columns: 测点, X, Y, 辺長. Includes points 0S21, 0S13, 231, 178, 0S22, 0S12 and summary statistics.

地籍 R9 table with columns: 测点, X, Y, 辺長. Includes points 489, 468, 487, 486, 467, 469, 465, 466, 465, 484, 483, 482, 441, 440, 450, 451, 452, 447, 448, 449, 448, 442, 439, 493 and summary statistics.

地籍 ZR1 table with columns: 测点, X, Y, 辺長. Includes points 186, 308, 307, 191, 192, M64, M61, 179 and summary statistics.

地籍 T7 table with columns: 测点, X, Y, 辺長. Includes points 462, 475, 474, 197, 246, M30, M31, 0262, 228, 236 and summary statistics.

地籍 T15 table with columns: 测点, X, Y, 辺長. Includes points 460, 440, 441, 462, 283 and summary statistics.

地籍 P table with columns: 测点, X, Y, 辺長. Includes points 463, 473, 474, 475, 462 and summary statistics.

地籍 R4 table with columns: 测点, X, Y, 辺長. Includes points 0S23, 179, 446, B17 and summary statistics.

地籍 R9 table with columns: 测点, X, Y, 辺長. Includes points 489, 468, 487, 486, 467, 469, 465, 466, 465, 484, 483, 482, 441, 440, 450, 451, 452, 447, 448, 449, 448, 442, 439, 493 and summary statistics.

成泰不動産 所 在 山口市宮野下字御藏本995,954 宇石合宗920字菊友1022,1023,1024 圖面名称 確定図求積表 (区域内) 圖面番号 2/3 山口市大内千坊二丁目 16番20号 青木正治

地籍 HR1 table with columns: 测点, X, Y, 辺長. Includes points 196, 247, M29, 246, 197 and area 3.320660.

地籍 KR2 table with columns: 测点, X, Y, 辺長. Includes points U13, 305, 304, 186, 181, M72, M69, U14 and area 6.07 m².

地籍 KW3 table with columns: 测点, X, Y, 辺長. Includes points GS2, 221, 298, 338 and area 4.09 m².

地籍 YW5 table with columns: 测点, X, Y, 辺長. Includes points GS22, 178, 186, 309 and area 0.97 m².

地籍 GKR5 table with columns: 测点, X, Y, 辺長. Includes points 325, 347, M15, 220, M16, 349, 351 and area 21.91 m².

地籍 GKW4 table with columns: 测点, X, Y, 辺長. Includes points 325, 348, 324, 323, 322, 321, 320, 146, 319, 143, 318, 317, 368, 185, GS14, 257, 268, 81, 100, 99, 98, 492, 361, 97, 265, 96, 95, 94, 347 and area 91.39 m².

地籍 HR2 table with columns: 测点, X, Y, 辺長. Includes points 356, 252, 251, 353, GS18 and area 12.2707765.

地籍 KR3 table with columns: 测点, X, Y, 辺長. Includes points U4, U5, U13, U14, M65 and area 2.26 m².

地籍 KW4 table with columns: 测点, X, Y, 辺長. Includes points 291, GS1, 337, 299 and area 0.12 m².

地籍 YW6 table with columns: 测点, X, Y, 辺長. Includes points B12, B11, GK7, GS7 and area 2.82 m².

地籍 GKW1 table with columns: 测点, X, Y, 辺長. Includes points 221, 205, 228, 204, 227, 203, 202, 201, 300, 345, 346, 344 and area 21.91 m².

地籍 GKW5 table with columns: 测点, X, Y, 辺長. Includes points 349, 350, 351, 347 and area 91.39 m².

地籍 SW1 table with columns: 测点, X, Y, 辺長. Includes points 488, 489, 265, 97, 361 and area 5.32 m².

地籍 KR4 table with columns: 测点, X, Y, 辺長. Includes points B10, B19, GS8, GS5, GS4, GS3, GS2, 338, 298, GP22, G4481, G4331, 299, 337, GS1, GK4, GK5, GK6, GK7, B11 and area 54.18 m².

地籍 KW5 table with columns: 测点, X, Y, 辺長. Includes points B16, B16, B11, B12 and area 1.86 m².

地籍 YW6 table with columns: 测点, X, Y, 辺長. Includes points 194, 301, 300, 201, M77, 195, 340, 345, 344 and area 9.69 m².

地籍 GKW1 续表 table with columns: 测点, X, Y, 辺長. Includes points 343, 342, 341, 340, 339, 298, 99, 700421 and area 49.86 m².

地籍 GKW6 table with columns: 测点, X, Y, 辺長. Includes points 349, 350, 351, 347 and area 3.67 m².

地籍 SW2-1 table with columns: 测点, X, Y, 辺長. Includes points 182, 359, 360, U6 and area 11.92 m².

地籍 KR5 table with columns: 测点, X, Y, 辺長. Includes points 185, 353, GS17, GS16, GS21, GS12, GS22, 309, 186, 179, GS23, B17, B16, 312, 310, 311, 313, 314 and area 48.20 m².

地籍 YR1 table with columns: 测点, X, Y, 辺長. Includes points 180, 187, 306, U5, U4 and area 2.80 m².

地籍 GKR2 table with columns: 测点, X, Y, 辺長. Includes points M15, 347, 326, 327, 328, 329, 330, 331, B11, 333, 334, 64, 86, M4, M5, M6, M7, M9, M10, M11, M12, M13, M14 and area 40.36 m².

地籍 GKW2 table with columns: 测点, X, Y, 辺長. Includes points G4332, 291, 299, 336 and area 9.02 m².

地籍 GKW7 table with columns: 测点, X, Y, 辺長. Includes points 298, 339, 340, 341, 342, 343, 344, 345, G4471, G4469, G4467, GP9, GP7, G4465, G4463, GP22 and area 33.46 m².

地籍 SW2-2 table with columns: 测点, X, Y, 辺長. Includes points 359, 239, U7, 360 and area 2.08 m².

地籍 KR6 table with columns: 测点, X, Y, 辺長. Includes points 185, 353, GS17, GS16, GS21, GS12, GS22, 309, 186, 179, GS23, B17, B16, 312, 310, 311, 313, 314 and area 48.20 m².

地籍 YR2 table with columns: 测点, X, Y, 辺長. Includes points B16, B17, B10, B11 and area 3.32 m².

地籍 GKR3 table with columns: 测点, X, Y, 辺長. Includes points 355, 363, 364, GS10, 366, GS18, 353, 185, 358 and area 12.64 m².

地籍 GKW3 table with columns: 测点, X, Y, 辺長. Includes points 347, 94, 93, 92, 91, 90, 295, 89, 88, G4350S, 335, 334, 333, 332, 331, 330, 329, 328, 327, 326 and area 52.12 m².

地籍 GKW8 table with columns: 测点, X, Y, 辺長. Includes points 349, 350, 351, 347 and area 3.67 m².

地籍 SW3 table with columns: 测点, X, Y, 辺長. Includes points B17, 445, 464, 458, 180, U4, 89, B10 and area 39.11 m².

地籍 KW1 table with columns: 测点, X, Y, 辺長. Includes points 238, GW15, GW14, 184, 302, M75, 209, 239 and area 10.65 m².

地籍 YW1 table with columns: 测点, X, Y, 辺長. Includes points 184, M75, 302, 193 and area 1.69 m².

地籍 GKR4 table with columns: 测点, X, Y, 辺長. Includes points 355, 363, 364, GS10, 366, GS18, 353, 185, 358 and area 12.64 m².

地籍 GKW4 table with columns: 测点, X, Y, 辺長. Includes points 347, 94, 93, 92, 91, 90, 295, 89, 88, G4350S, 335, 334, 333, 332, 331, 330, 329, 328, 327, 326 and area 52.12 m².

地籍 GKW9 table with columns: 测点, X, Y, 辺長. Includes points 349, 350, 351, 347 and area 3.67 m².

地籍 SW4 table with columns: 测点, X, Y, 辺長. Includes points 257, GS14, GK22, B8, B7, B14, B15, B12, B13, 462, 464, 465, 466 and area 67.06 m².

地籍 KW2 table with columns: 测点, X, Y, 辺長. Includes points 187, 240, 182, U6, U5, 306 and area 3.87 m².

地籍 YW2 table with columns: 测点, X, Y, 辺長. Includes points U12, M71, M74, 183, 188, 304, 305, U13 and area 7.55 m².

地籍 GKR5 table with columns: 测点, X, Y, 辺長. Includes points 355, 363, 364, GS10, 366, GS18, 353, 185, 358 and area 12.64 m².

地籍 GKW5 table with columns: 测点, X, Y, 辺長. Includes points 347, 94, 93, 92, 91, 90, 295, 89, 88, G4350S, 335, 334, 333, 332, 331, 330, 329, 328, 327, 326 and area 52.12 m².

地籍 GKW10 table with columns: 测点, X, Y, 辺長. Includes points 349, 350, 351, 347 and area 3.67 m².

地籍 KR1 table with columns: 测点, X, Y, 辺長. Includes points 193, 302, 194, 195, M76 and area 1.41 m².

地籍 KW3 table with columns: 测点, X, Y, 辺長. Includes points 187, 240, 182, U6, U5, 306 and area 3.87 m².

地籍 YW3 table with columns: 测点, X, Y, 辺長. Includes points U5, U6, M70, U12, U13 and area 3.03 m².

地籍 GKR6 table with columns: 测点, X, Y, 辺長. Includes points 355, 363, 364, GS10, 366, GS18, 353, 185, 358 and area 12.64 m².

地籍 GKW6 table with columns: 测点, X, Y, 辺長. Includes points 347, 94, 93, 92, 91, 90, 295, 89, 88, G4350S, 335, 334, 333, 332, 331, 330, 329, 328, 327, 326 and area 52.12 m².

地籍 GKW11 table with columns: 测点, X, Y, 辺長. Includes points 349, 350, 351, 347 and area 3.67 m².

地籍 KR2 table with columns: 测点, X, Y, 辺長. Includes points 187, 240, 182, U6, U5, 306 and area 3.87 m².

地籍 KW4 table with columns: 测点, X, Y, 辺長. Includes points GS14, 186, 314, 313, 311, 310, 312, B15, B15, GK10, GK11, GK21, GK22 and area 63.76 m².

地籍 YW4 table with columns: 测点, X, Y, 辺長. Includes points U5, U6, M70, U12, U13 and area 3.03 m².

地籍 GKR7 table with columns: 测点, X, Y, 辺長. Includes points 355, 363, 364, GS10, 366, GS18, 353, 185, 358 and area 12.64 m².

地籍 GKW7 table with columns: 测点, X, Y, 辺長. Includes points 347, 94, 93, 92, 91, 90, 295, 89, 88, G4350S, 335, 334, 333, 332, 331, 330, 329, 328, 327, 326 and area 52.12 m².

地籍 GKW12 table with columns: 测点, X, Y, 辺長. Includes points 349, 350, 351, 347 and area 3.67 m².

地籍 GKR8 table with columns: 测点, X, Y, 辺長. Includes points 355, 363, 364, GS10, 366, GS18, 353, 185, 358 and area 12.64 m².

地籍 GKW8 table with columns: 测点, X, Y, 辺長. Includes points 347, 94, 93, 92, 91, 90, 295, 89, 88, G4350S, 335, 334, 333, 332, 331, 330, 329, 328, 327, 326 and area 52.12 m².

成泰不動産
所 在 山口市宮野下字御藏本995, 954
字石合宗920 字菊友1022, 1023, 1024
図面名称 確定図求積表(区域内・外)
図面番号 3/3
山口市大内千坊二丁目
16番20号 青木正治